

ITEM NO.	PART NUMBER	DESCRIPTION	QTY.
1	210-00017	.50" FLAT WASHER	2
2	210-00025	.375" FLAT WASHER	4
3	210-00047	.50"-13 NYLOCK HEX NUT	2
4	210-00048	.375"-16 NYLOCK HEX NUT	4
5	210-00120	.50"-13 X 1.50" HX HD BOLT	2
6	210-00239	.375"-16 X 3.125" X 2.875" U-BOLT	2
7	210-00323	.50"-13 JAM TOP LOCK NUT	2
8	300-01476	SPARE TIRE CARRIER	1

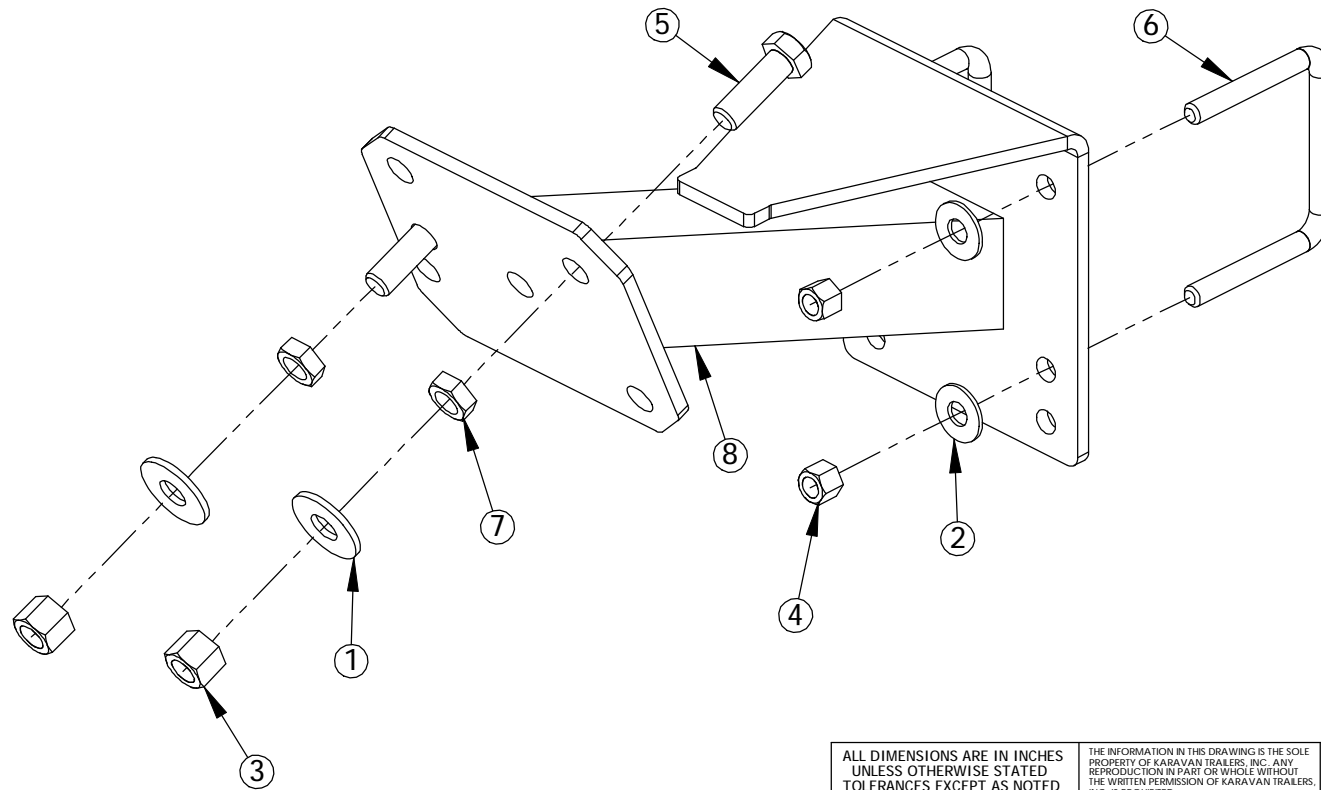

ALL DIMENSIONS ARE IN INCHES  
UNLESS OTHERWISE STATED  
TOLERANCES EXCEPT AS NOTED  
DECIMALS:  
.X ±0.100  
.XX ±0.060  
.XXX ±0.030  
.XXXX ±0.010  
ANGLES:  
±1°  
ALL FORMED ANGLES  
EQUAL 90° UNLESS  
NOTED OTHERWISE  
( ) INDICATES REFERENCE

THE INFORMATION IN THIS DRAWING IS THE SOLE  
PROPERTY OF KARAVAN TRAILERS, INC. ANY  
REPRODUCTION IN PART OR WHOLE WITHOUT  
THE WRITTEN PERMISSION OF KARAVAN TRAILERS,  
INC. IS PROHIBITED.

APPROVED BY:  
**C- RICHTER**

DRAWN BY:  
**TINA MCCOY**

DATE:  
**09-27-04**

SHEET:  
**1 OF 1**

SCALE:  
**N/A**

**KARAVAN**  
TRAILERS

TITLE:  
**SIDE MOUNT TIRE CARRIER,  
2 X 3 (5-BOLT)**

MAT'L:  
**SEE B.O.M.**

FINISH:  
**N/A**

DWG. #:  
**320-01428-C**

DWG. REV.	ECR/NDR NUMBER	REVISED BY	DATE	DESCRIPTION
C	14035	DLC	01-22-09	ADDED 210-0323 (2X)
B	13141	NLA	06-22-06	300-01476 UPDATED